

O60RF

Wireless radiator actuator Intellicomfort+ system

O60RF opens or closes the radiator water flow valve to maintain the room temperature set on the CH180RF/CH120RF weekly programmable thermostat or thermostat for the zone.



Dimensions (mm)

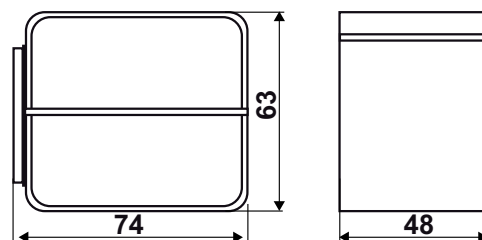

	Power supply	Transceiver frequency	Operating temperature	Valve connection	Protection degree
O60RF	2 batteries AA 1,5V	Wireless 868MHz	0 ÷ 50°C	M30X1,5	IP30

ELECTRICAL CHARACTERISTICS

- Power supply with two 1.5V AA alkaline batteries;
- Transceiver frequency: 868MHz;
- Maximum radio frequency power transmitted < 10mW.

INSTALLATION

- The wireless actuator can be quickly and easily mounted on all common valves with 30x1,5 thread.
- Scope of delivery: 1 O60RF actuator, 1 coupling ring, 1 adapters set with four parts, 1 screw and nut, 1 removing tool and this installation manual.

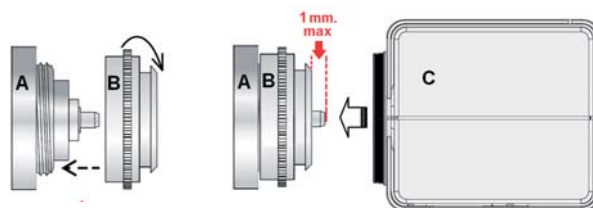

HOMOLOGATION AND STANDARDS

- Complies with 2004/108/CE standards;
- Responding to Directive 2014/53 / EU (RED) .



OPERATION

- The O60RF wireless actuator replaces the radiator thermostatic head or manual regulator already present on the thermostatable valve; the actuator acting on the valve piston opens or closes the flow of water to maintain the ambient temperature set on the CH180RF / CH120RF series programmable thermostat or thermostat.
- O60RF permits regulation in either of two ways:
 - If associated with a zone without thermostat, the current set point is received by CH180RF "MASTER" and regulates the temperature according to the current one detected by its internal sensor.
 - If associated with a zone with CH120RF thermostat, the current set point is received by the thermostat itself and regulates the temperature according to the reading of the thermostat of the zone.



SYSTEM EXAMPLE

CENTRALIZED SYSTEM WITH RADIATORS

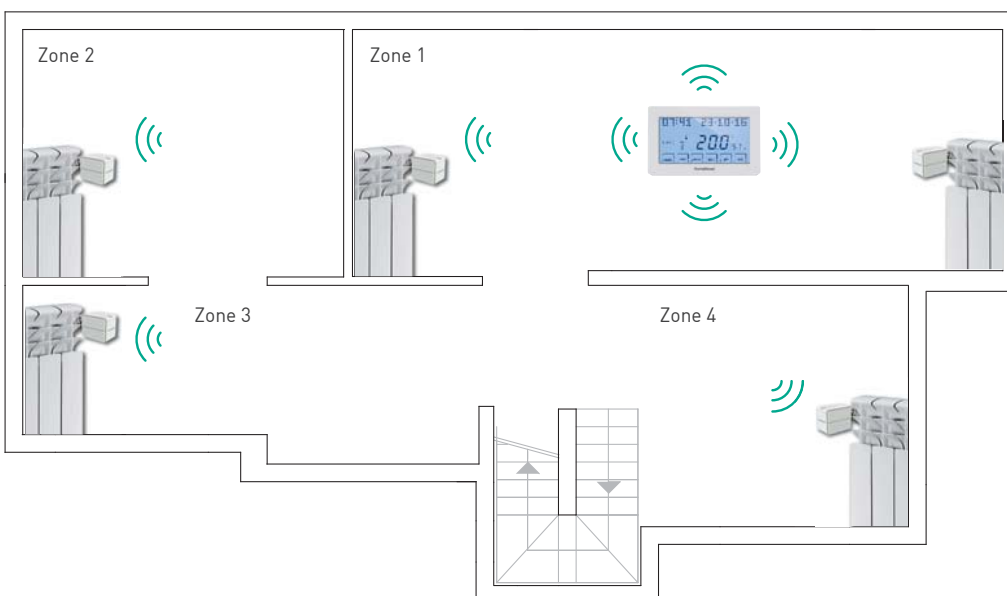

- CH180RF "MASTER" programmable thermostat directly controls the O60RF radiator actuators.
- The O60RF receive the current set point from the programmable thermostat and regulate the temperature according to data detected by their internal sensors.

AUTONOMOUS SYSTEM WITH BOILER AND RADIATORS (POSITIONED IN NOT OPTIMAL LOCATION)

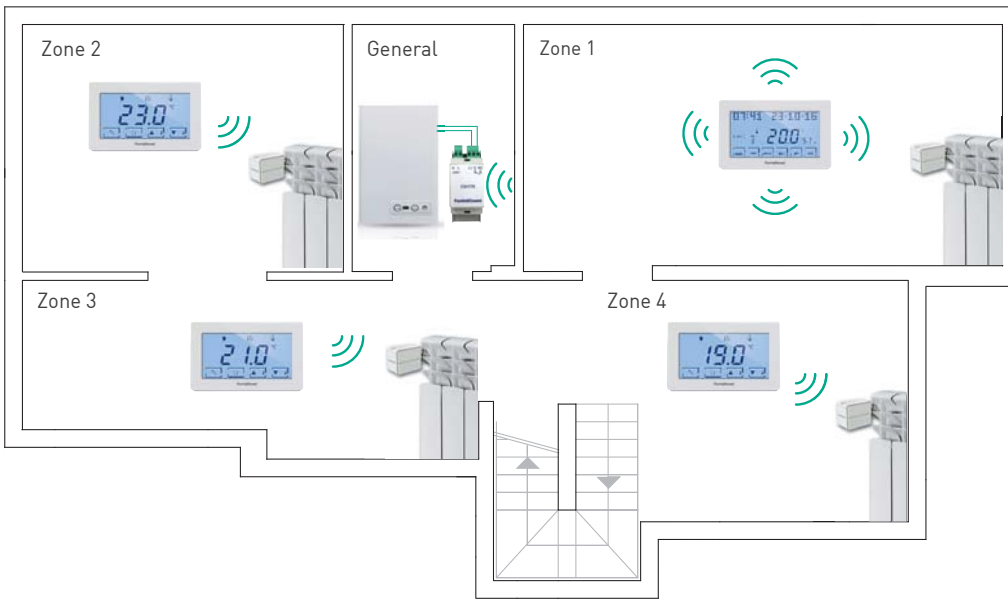

- CH180RF "MASTER" controls CH120RF zone thermostats which regulate the temperature in the zone and communicate with the O60RF actuators in the same zone.
- O60RF receives the set point and regulates the temperature according to the reading one detected by the zone thermostat
- CH175 actuator activates the boiler and also acts as a repeater for the wireless network of the Intellicomfort+ system, extending the range of the system.

SYSTEM CONFIGURATION

- The actuator must be included in the system / network in order to function; This operation requires the use of the configurator 1590880 which, through the display provided, gives the operating instructions.
- When required, the remote control must be approached by the actuator to perform contact recognition.
- For more details, refer to the Intellicomfort + wireless multi-zone installation manual.



CHARACTERISTICS

- Protection degree IP 30;
- Operating temperature: 0 ÷ 50°C;
- Storage temperature: -20 ÷ +70°C;
- Shape type: white ABS plastic;
- Compact case;
- Dimensions: 48x63x74mm
- Valve connection: M30x1,5 - different adapters are available for other types of valves;
- Danfoss adapters (RA, RAV, RAL model) included;
- Internal temperature sensor.

COMPATIBILITY

O60RF is compatible with the following thermostatic radiator valves brands:

BRAND	ADAPTER CODE
Luxor	unnecessary
Honeywell	unnecessary
Oventrop	unnecessary
Caleffi (338, 339, 401, 402, 421, 425, 426, 4001, 4003, 4004, 3380, 455)	309703
Caleffi	309706
Danfoss (RA)	included
Danfoss (RAV)	included
Danfoss (RAVL)	included
Watts /Cazzaniga	unnecessary
FAR	309706
R.B.M.	309706
Giacomini	309704
Itap	unnecessary
Herz	309705
Siemens	309706

- Cod. 309703: adapter for Caleffi valve



- Cod. 309704: adapter for Giacomini valve



- Cod. 309705: adapter for Herz valve



- Cod. 309706: adapter for M30x1,5 valve

